

MYCOM



A line of rugged oil injected, integral gear box, screw compressors designed specifically for engine driven field gas applications. With multiple gear ratios, there is more capacity available with a simple gear change regardless of your engine speed.

VR-Series Field Gas Screw Compressor
from the world's leading oil flooded screw compressor manufacturer

MAYEKAWA



VR - SERIES

STANDARD FEATURES

- ASTM A48M (equiv)-45B cast iron casing, MAWP 350 psig
- ASTM A-536 80-55-06 (equiv) ductile iron rotors
- Single oil flooded mechanical seal
- Engine or motor driven with gears for more capacity
- Viton O-rings
- 10 ~ 100% hydraulically actuated slide valve
- Position indicator and potentiometer
- Hydrodynamic API 619 / NACE compliant journal bearings
- Dynamically balanced integral gear with internal lube system
- Manually adjustable volume ratio 2.63 ~ 5.8
- Operating suction pressure to 85 psig
- Operating discharge pressures to 313 psig

VR-SERIES MODEL NAME DESIGNATION

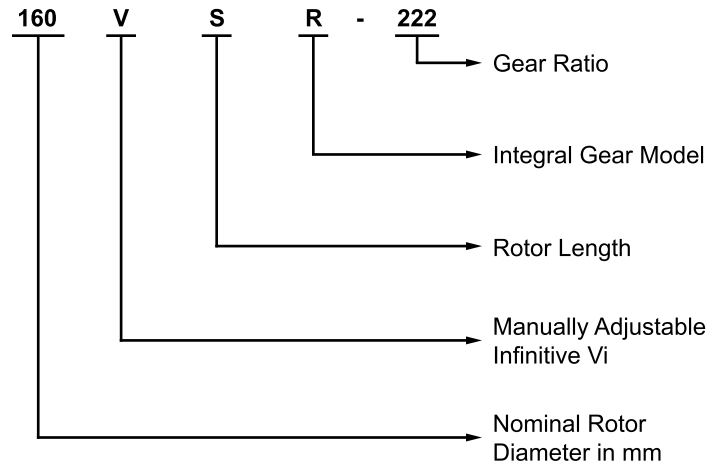

OPTIONS

- Integral oil pump
- Manual slide valve adjuster
- Double balanced, Dual, Dry mechanical seals

Models and Displacements

MODEL	CFM Displacement @ 1800RPM Input
160VSR-149	222
160VSR-181	270
160VSR-222	331
160VLR-149	333
160VLR-181	404
160VLR-222	496
200VSR-169	492
200VSR-193	562
200VSR-222	647
200VLR-169	736
200VLR-193	842
200VLR-222	965
250VSR-187	1060
250VSR-217	1230
250VSR-245	1390
250VSR-187	1590
250VLR-217	1840

Dimensions

Approx. Dimensions		COMPRESSOR MODELS					
		160VSR	160VLR	200VSR	200VLR	250VSR	250VLR
A	inch	48.25	51.79	57.26	61.67	70.73	76.28
B	inch	20.12		24.85		31.07	
C	inch	18.25		22.22		27.82	
D	inch	21.96		29.39		36.39	

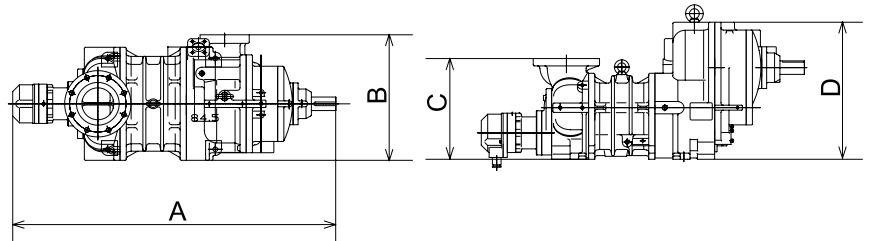

www.mayekawa.ca
www.mayekawa.com

'Natural' is what we design for!

Vancouver
12180 Riverside Way,
Richmond, BC V6W 1K5
Phone: (604) 270-1544
Fax: (604) 270-7890

Calgary
4525 6A Street NE,
Calgary, AB T2E 4B2
Phone: (403) 250-1554
Fax: (403) 250-1504

Toronto
Unit #6, 1745 Bonhill Rd,
Mississauga, ON L5T 1C1
Phone: (905) 564-0664
Fax: (905) 564-7614